

PROJECT:	UNIT TAG:	QUANTITY:
REPRESENTATIVE:	TYPE OF SERVICE:	DATE:
ENGINEER:	SUBMITTED BY:	DATE:
CONTRACTOR:	APPROVED BY:	DATE:
	ORDER NO.:	



COMFORT 10-16 DT PM BU/LC

Domestic hot water pumps

Product photo could vary from the actual product

Conditions of Service		Pump Data		Motor Data	
Liquid:	Water	Maximum operating pressure:	145.04 psi	Max. power input:	6 W
Temperature:	140 °F	Liquid temperature range:	35.6 .. 203 °F	Main frequency:	60 Hz
Specific Gravity:	0.985	Approvals:	UL,CSA	Enclosure class:	IP44
		Flange standard:	USA Union	Insulation class:	F
		Pipe connection:	1 1/4" NPSM	Motor protection:	NONE
		Product number:	99812354	Thermal protection:	Impedance protected

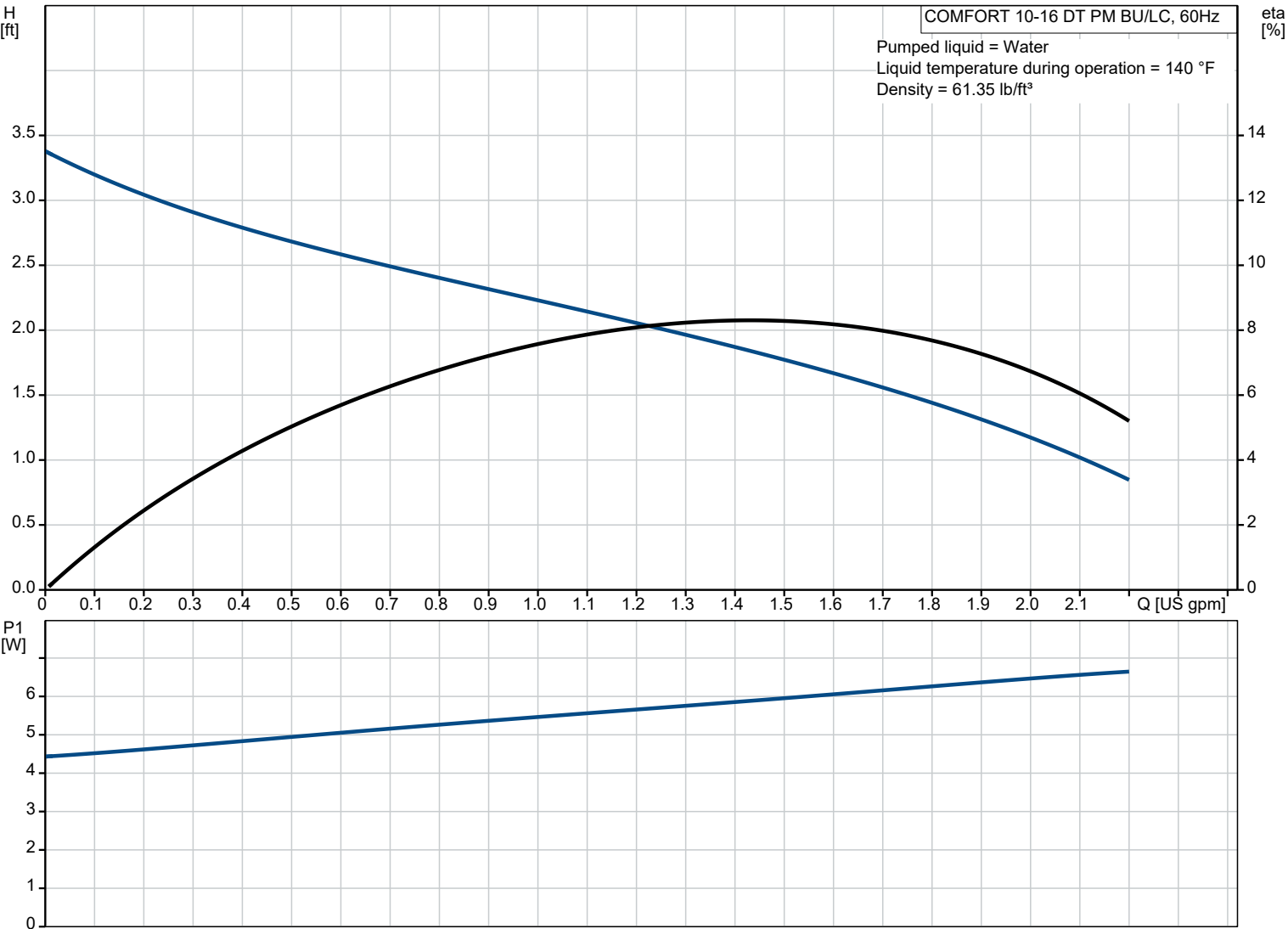

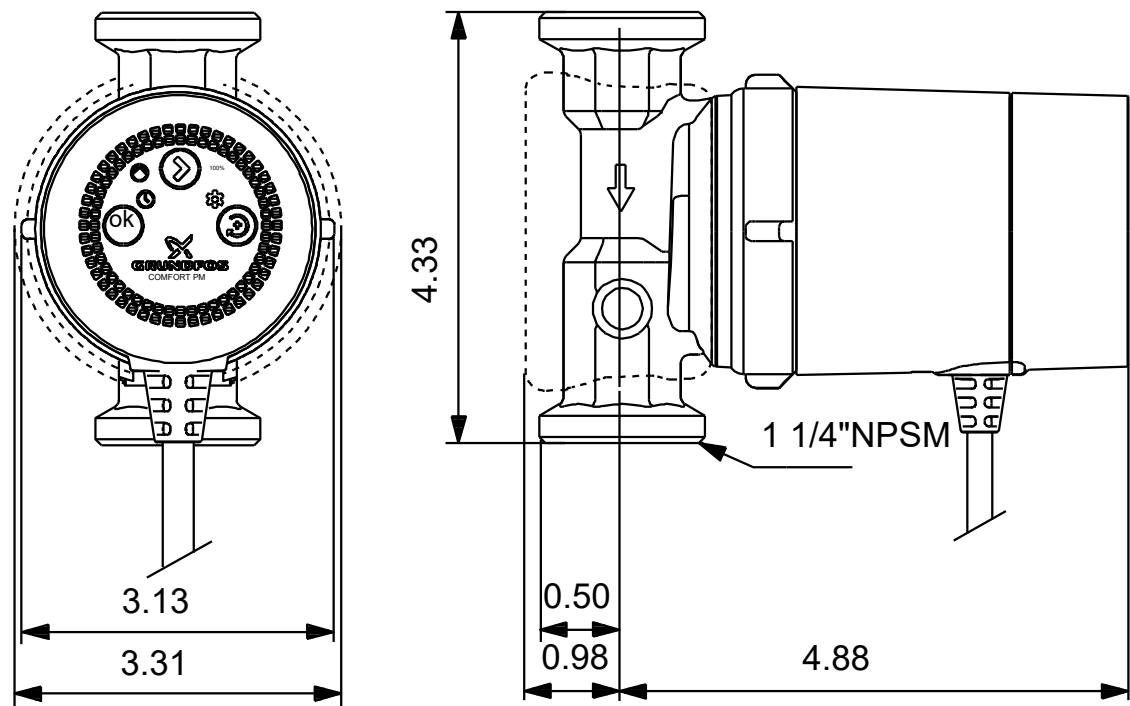

**Materials:**  
Pump housing: Ecobrase  
Impeller: Stainless steel, EPDM, PPO, PTFE, Graphit

Count	Description
1	<p><b>COMFORT 10-16 DT PM BU/LC</b></p>  <p>Product photo could vary from the actual product</p> <p>Product No.: <a href="#">99812354</a></p> <p>The high-efficiency Grundfos COMFORT 10-16 DT PM BU/LC pump are designed for recirculation of domestic hot water in single - and two-family houses securing hot water instantly to all faucets. The pumps have a corrosion-resistant pump housing suitable for drinking water and are powered by a single-phase, high-efficiency ECM with permanent-magnet rotor.</p> <p>The integrated digital timer has been developed for domestic hot-water recirculation in systems with either hot-water tanks or plate heat exchangers for hot-water production. The timer allows you to customise the pump's operating periods, ensuring optimal comfort while lowering energy costs. Additionally, the pump can be set to continuous operation 100 %.</p> <p>COMFORT 10-16 DT PM BU/LC has a built-in isolating valve and a non-return valve. This ensures that maintenance can be carried out without draining the system. The non-return valve also prevents reversed flow during operation.</p> <p>Features and benefits:</p> <ul style="list-style-type: none"> <li>Continuous operation can be set for commissioning of the pump or 24 hours instant hot shower and tap water.</li> <li>Quick and simple electrical installation.</li> <li>Dry-running protection protects the pump against dry running during startup and normal operation.</li> <li>Easy-to-clean and lime-resistant spheric rotor.</li> <li>Noiseless operation due to liquid-lubricated bearing.</li> <li>No leakage risk due to a static seal.</li> <li>Easy maintenance and cleaning through the easy-to-separate pump head.</li> <li>No additional motor protection necessary due to integrated motor electronics.</li> </ul>